

EXAGERO VERTICAL 2

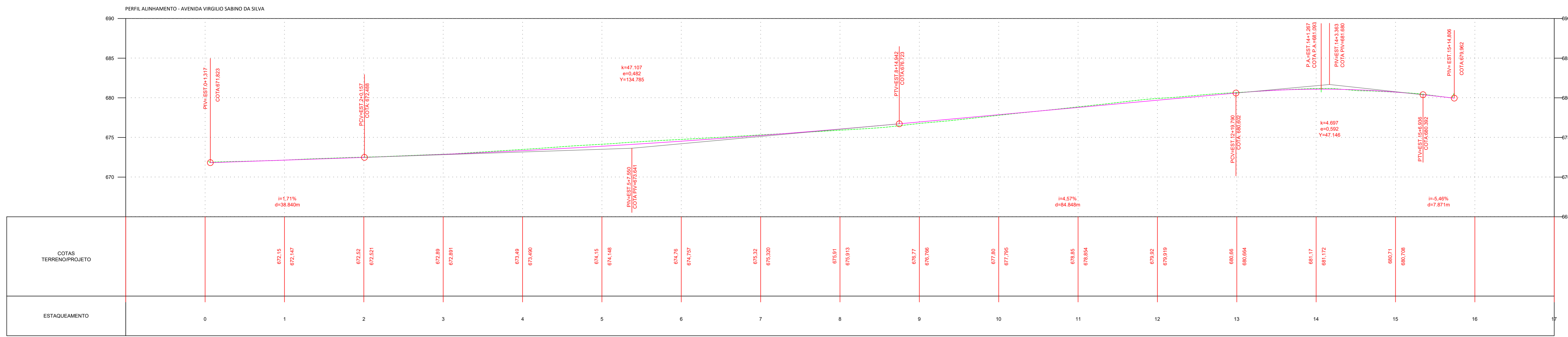

DETALHE SINALIZAÇÃO

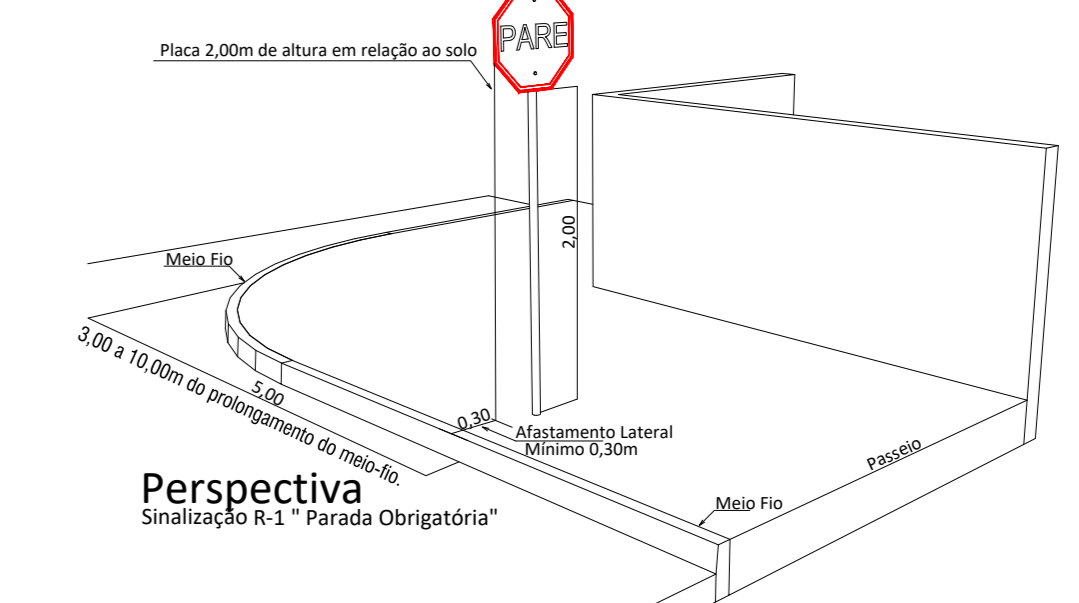

Planta Baixa

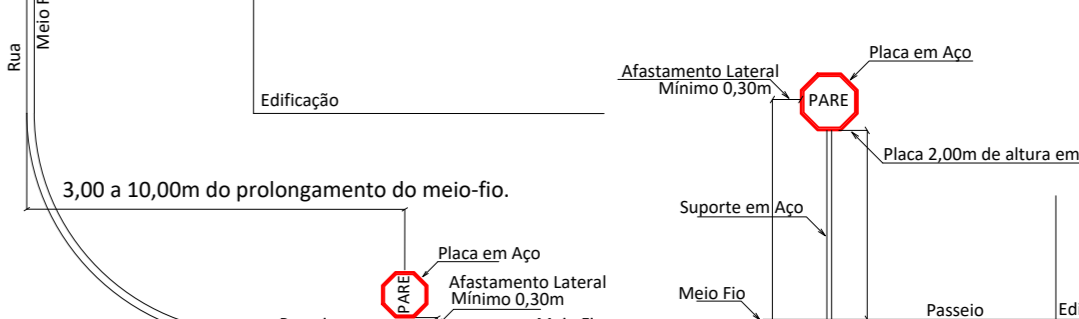

Detalhe Frontal



SITUAÇÃO ATUAL



PROJETO DRENAGEM PLUVIAL

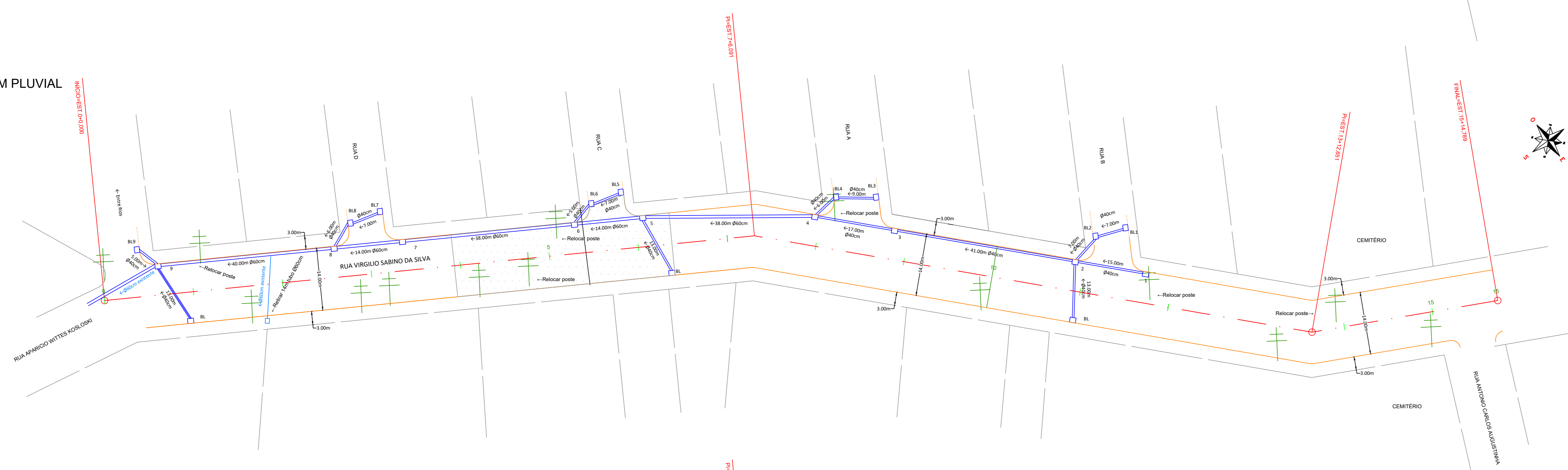

PROJETO PAVIMENTAÇÃO E SINALIZAÇÃO

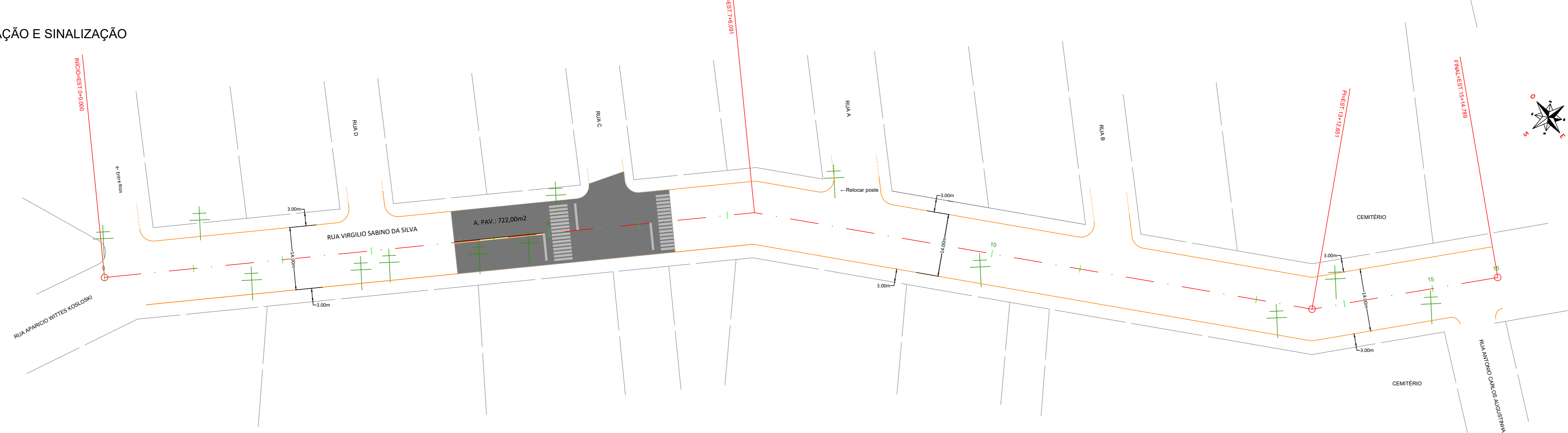

BOCA DE LOBO

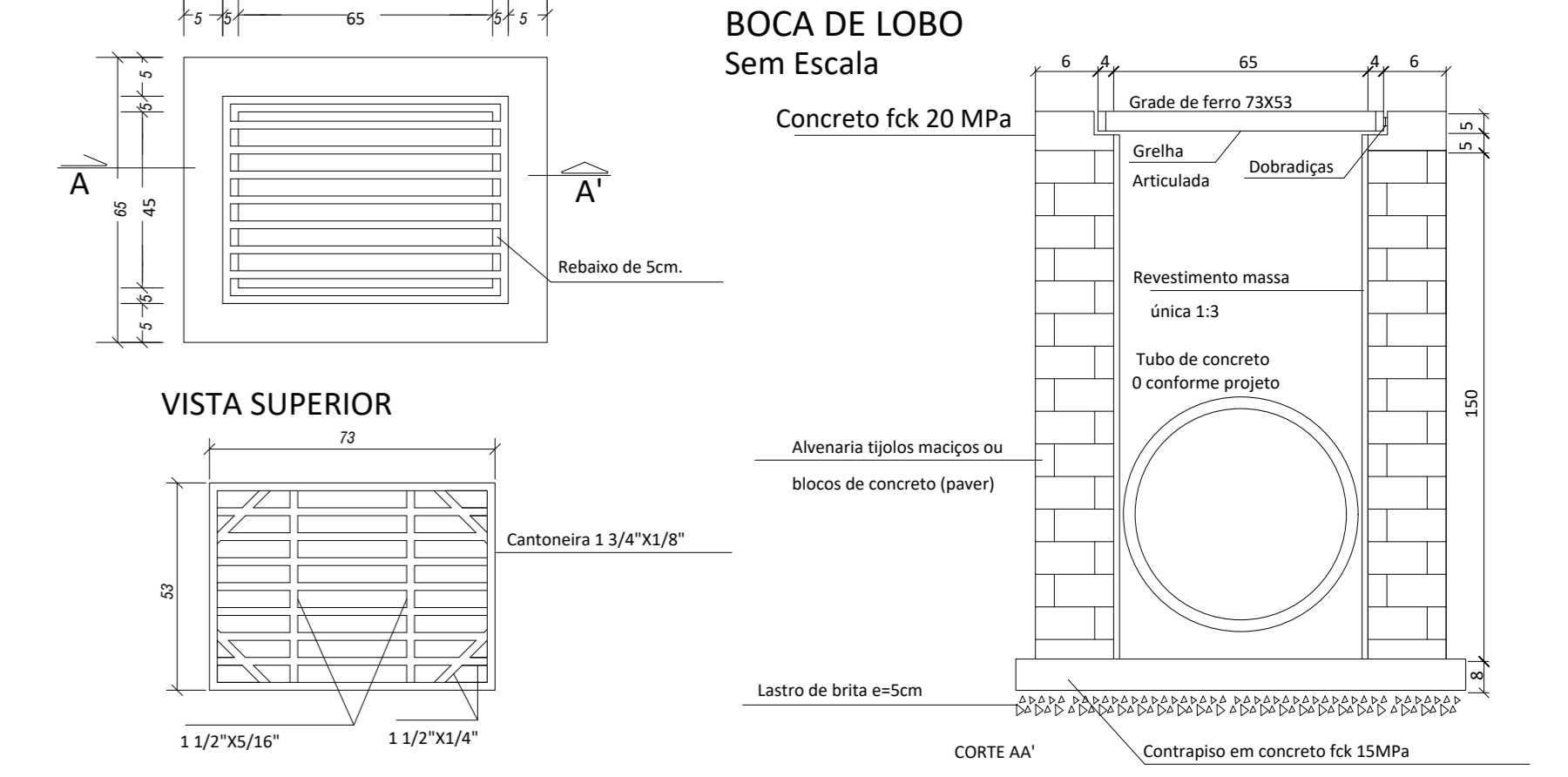

DETALHE GRADE DE FERRO



Meio-Fio

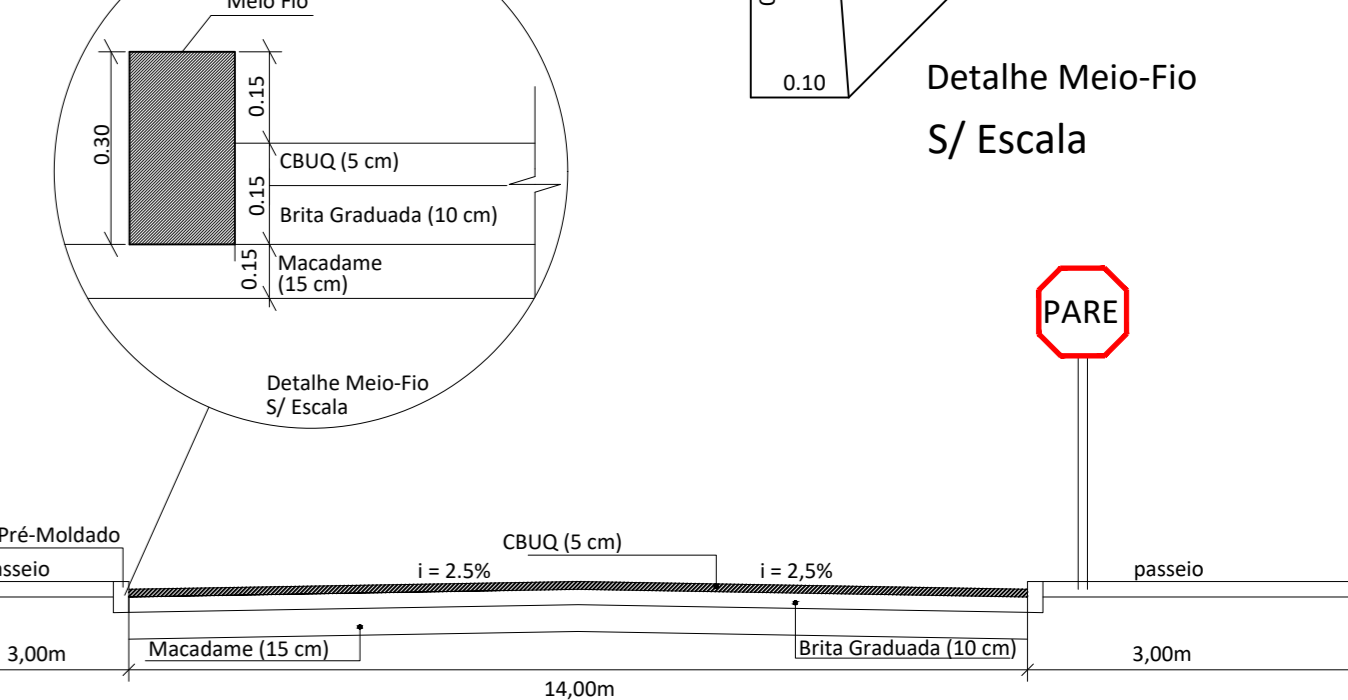

DETALHE SINALIZAÇÃO HORIZONTAL

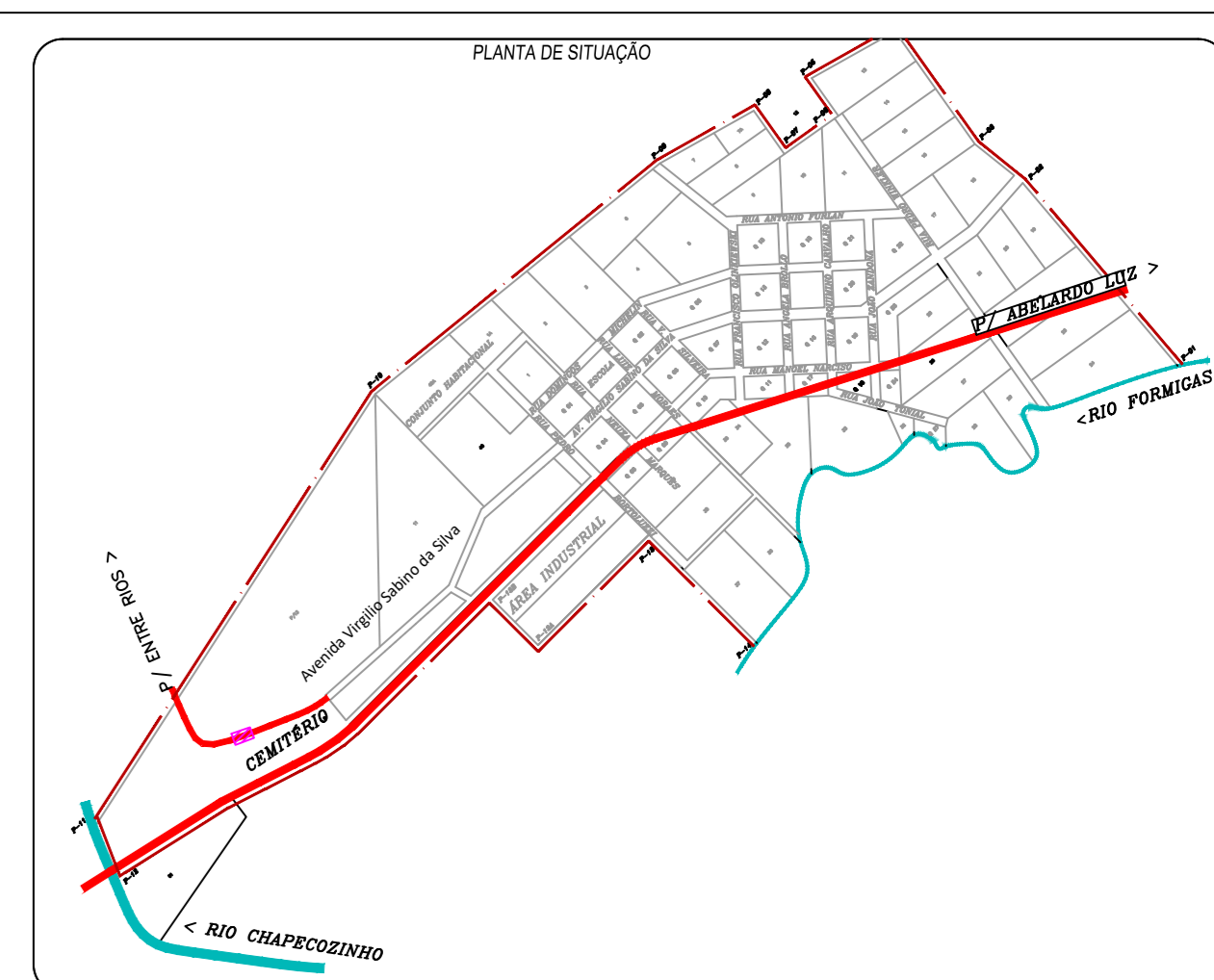
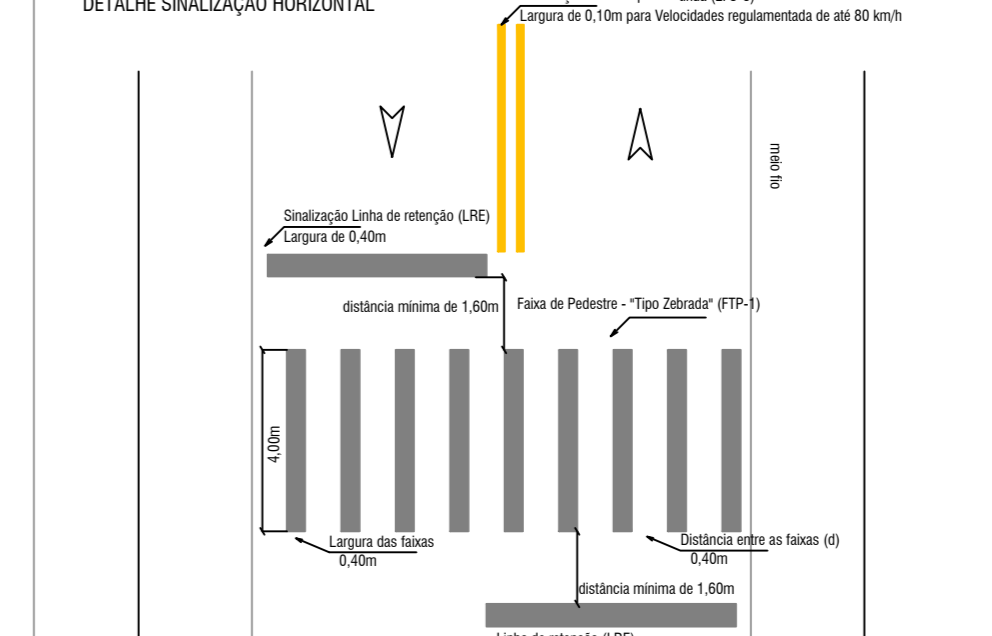

PROJETO DE PAVIMENTAÇÃO

Folha: Única

RUA: AVENIDA VIRGÍLIO SABINO DA SILVA - Trecho 02 Entre a Rua Aparício W. Koski e Rua Antônio C. Augustinho

MUNICÍPIO(S): BOM JESUS ESTADO UF: SC

DATA: 02/2022 ESCALA: 1:500

Proj: PREFEITURA MUNICIPAL DE BOM JESUS

Resp. Téc: CARLOS ALEXANDRE ROMANI

BOM JESUS - SC GOVERNO MUNICIPAL R. Manoel Neves, 464 - Centro CEP: 89624-000 - Fone: (49) 3424-0181 www.bomjesus.sc.gov.br