

EXAGERO VERTICAL 2

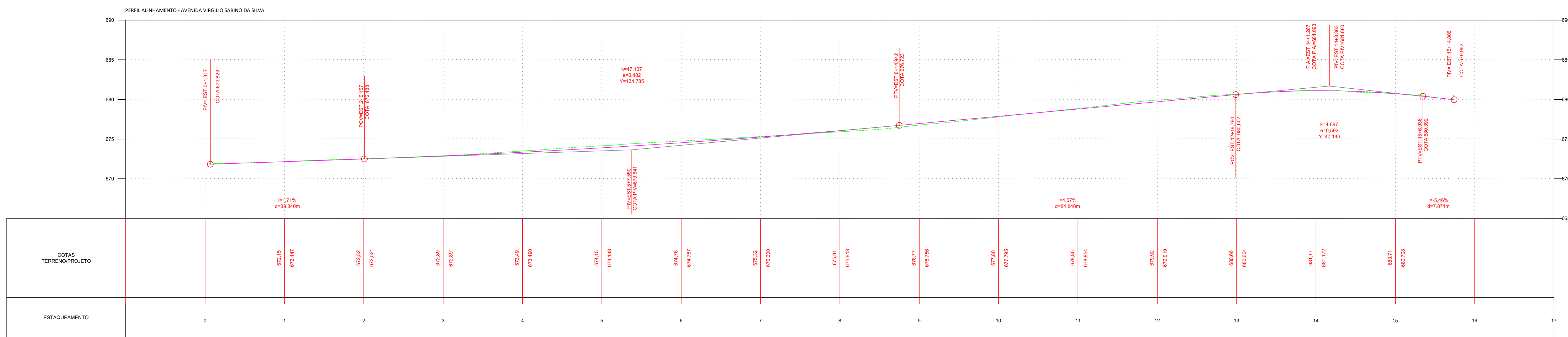

SITUAÇÃO ATUAL



PROJETO DRENAGEM PLUVIAL

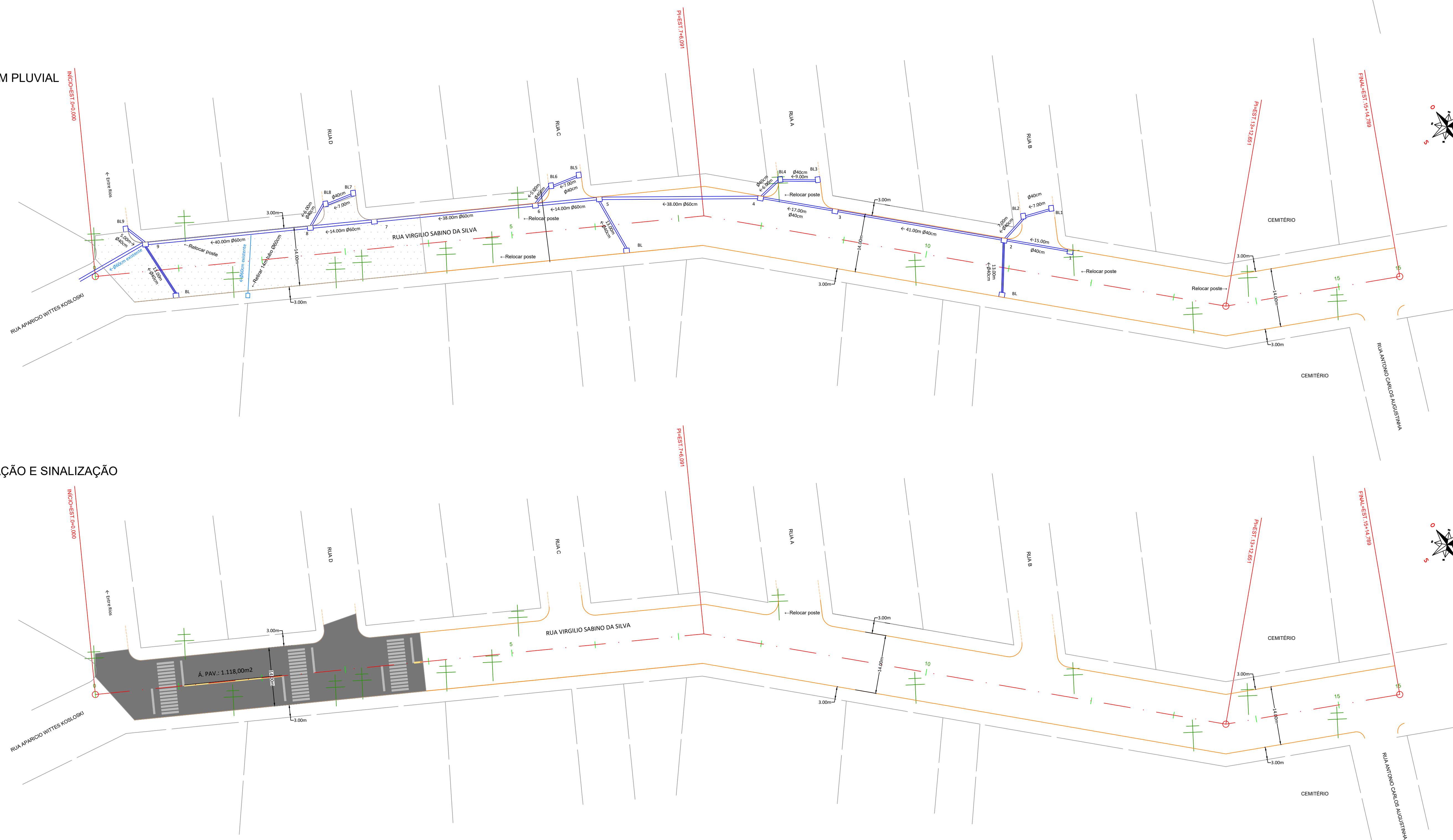

PROJETO PAVIMENTAÇÃO E SINALIZAÇÃO

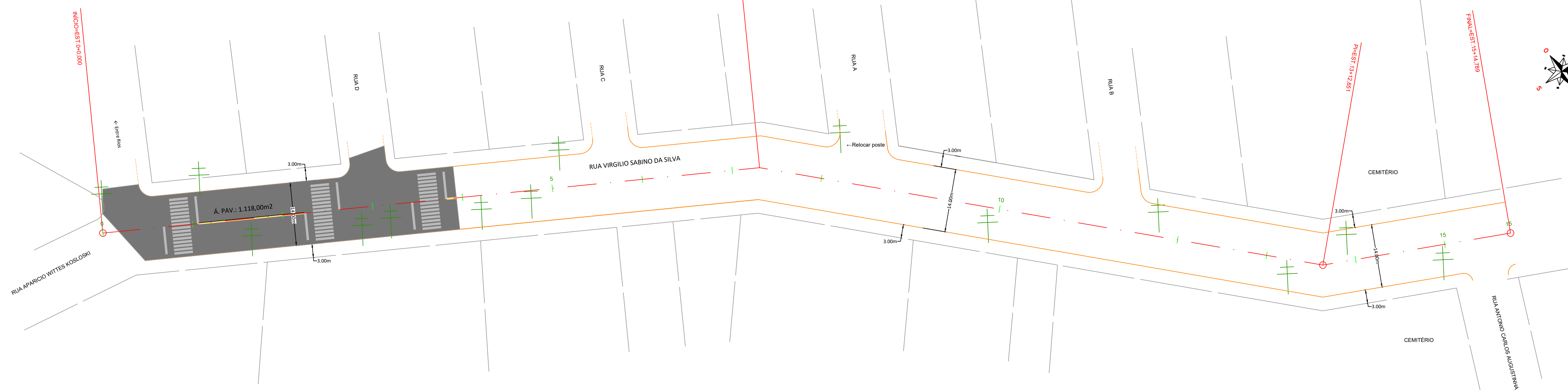

DETALHE SINALIZAÇÃO

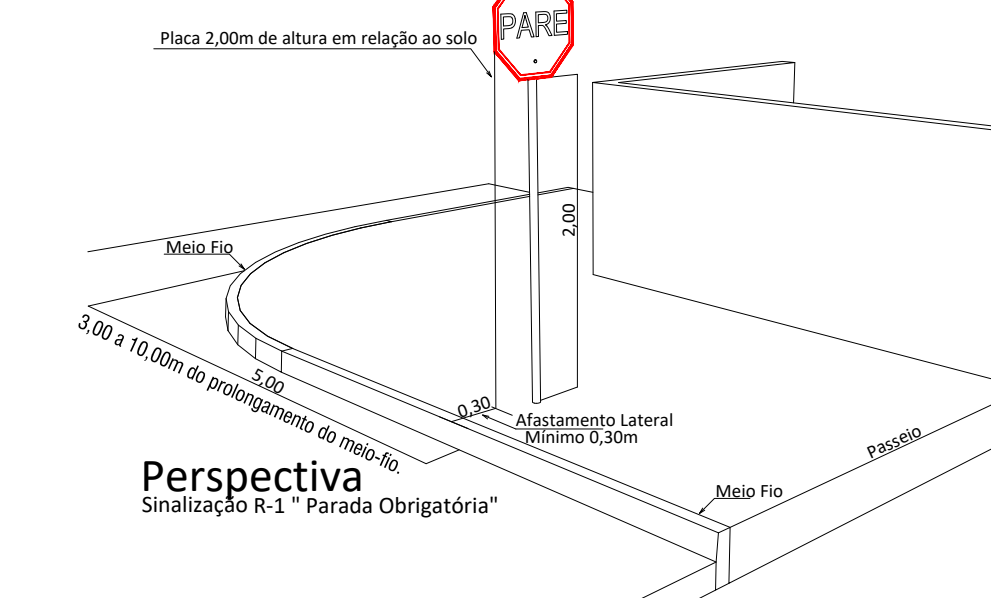

Planta Baixa



Detalhe Frontal

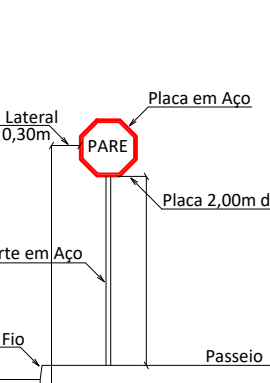

BOCA DE LOBO

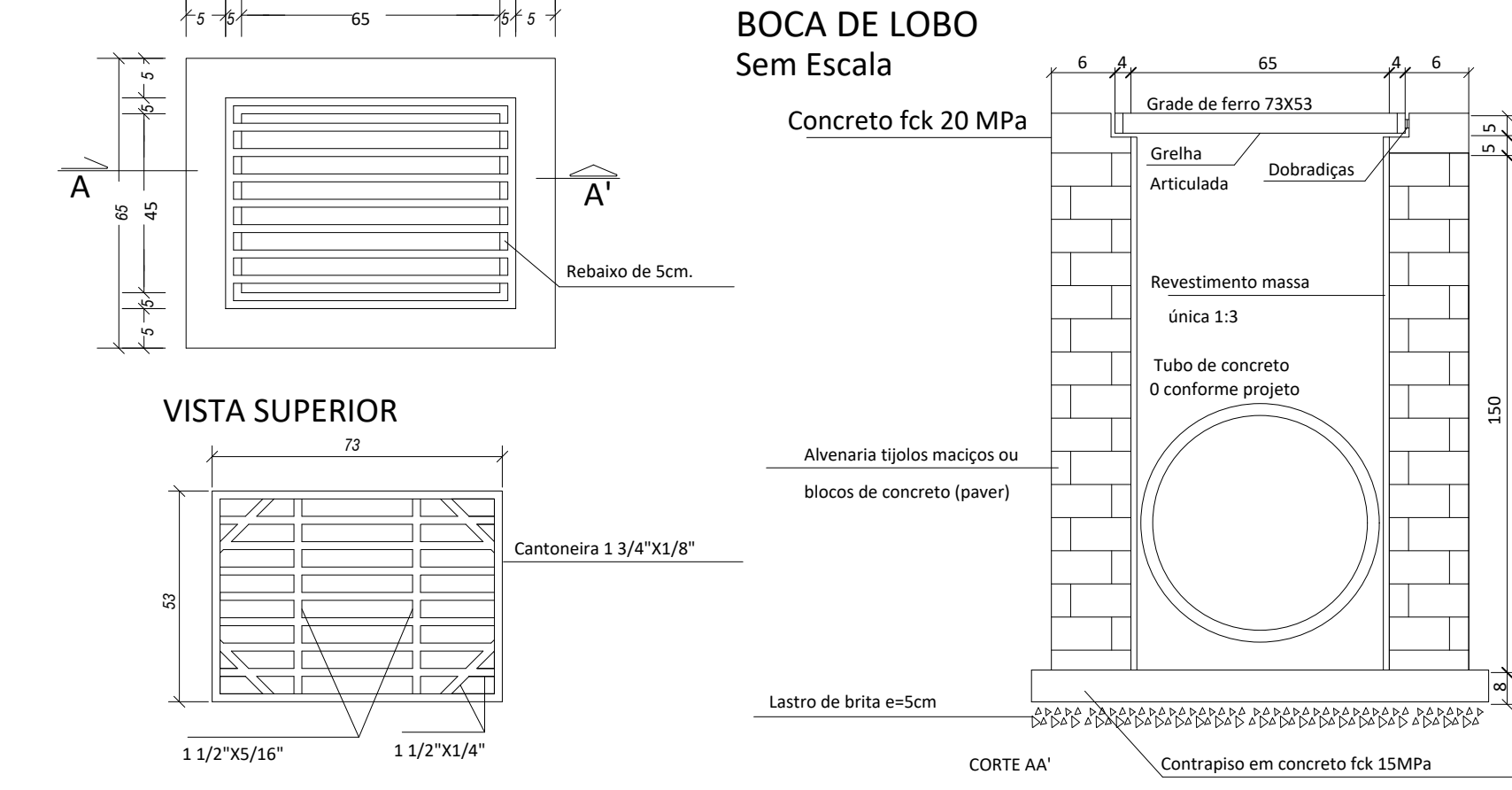

DETALHE GRADE DE FERRO

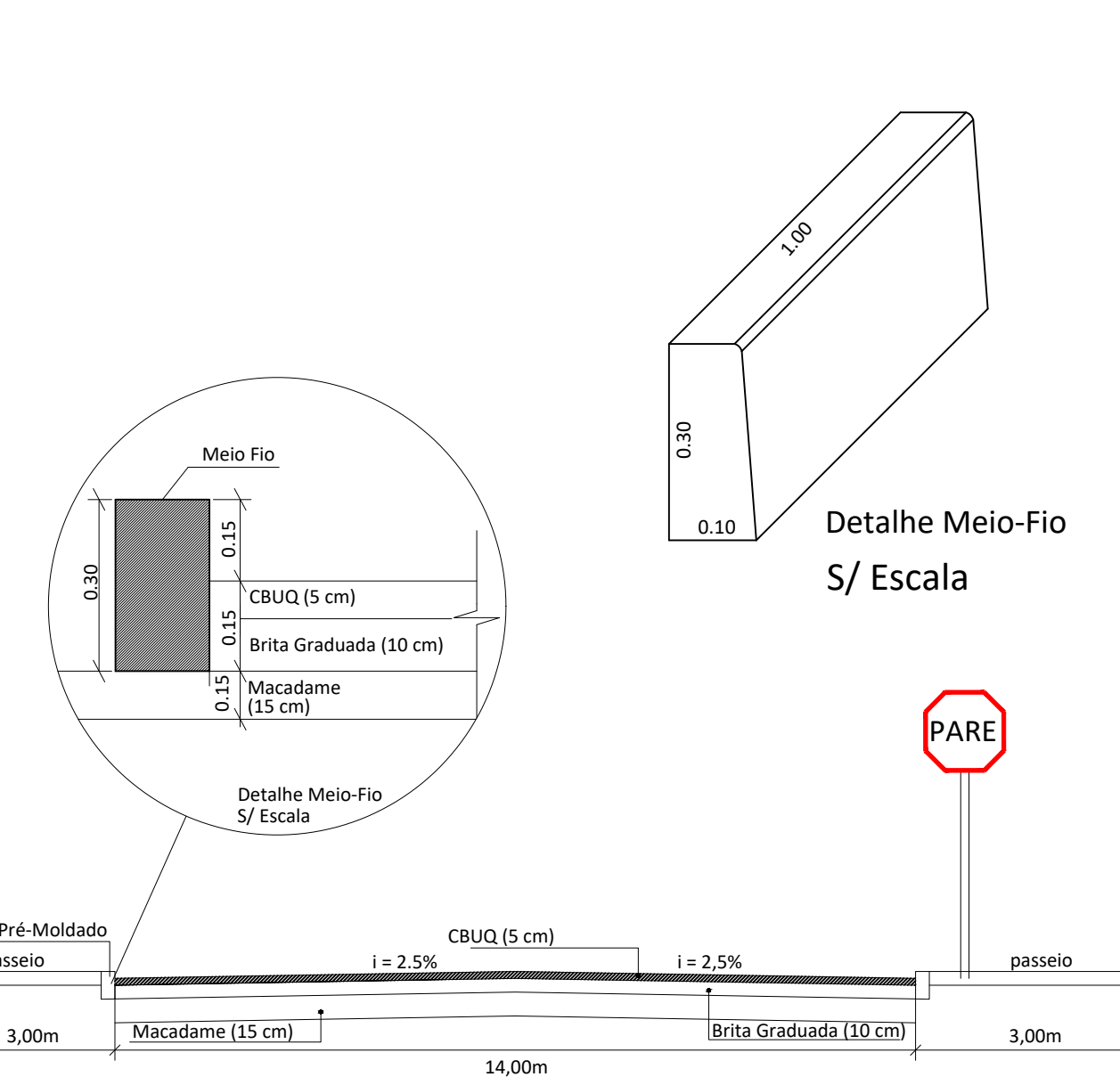

DETALHE SINALIZAÇÃO HORIZONTAL

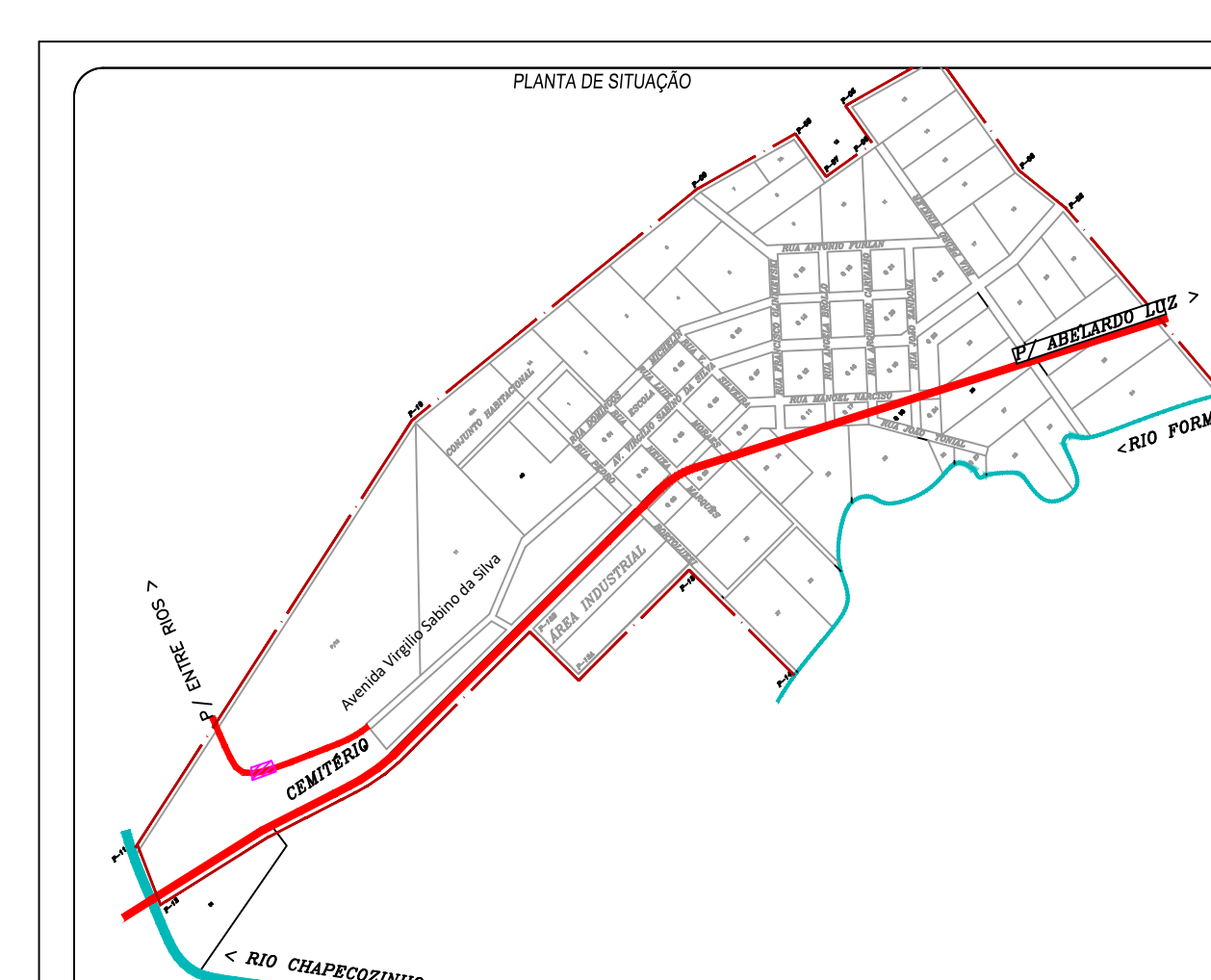
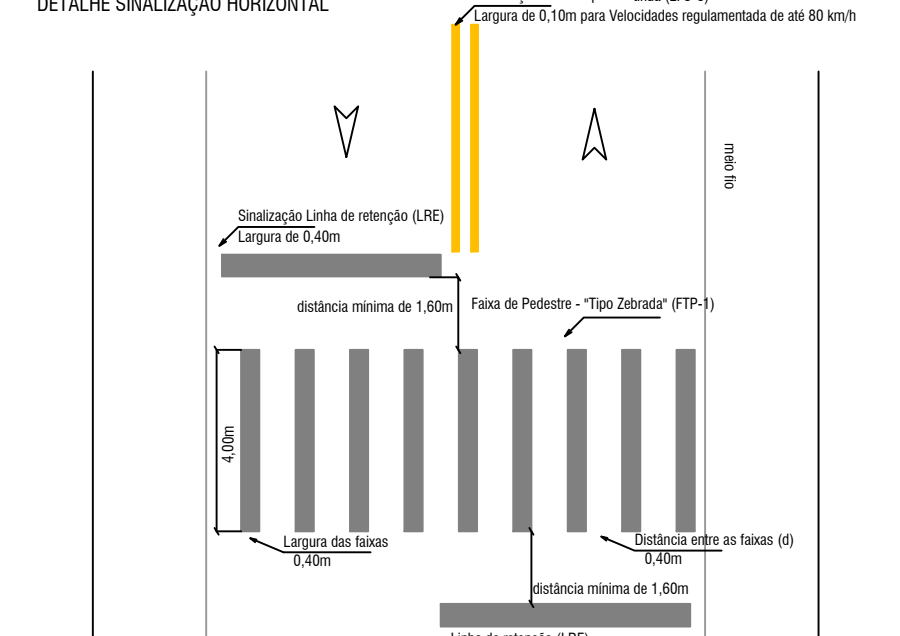

**PROJETO DE PAVIMENTAÇÃO**

Forma: Única

RUA: AVENIDA VIRGÍLIO SABINO DA SILVA - Trecho 01 Entre a Rua Aparício W. Kozłowski e Rua Antônio C. Augustinho  
 MUNICÍPIO(S): BOM JESUS ESTADO UF: SC  
 DATA: 02/2022 ESCALA: 1:500

Prop: PREFEITURA MUNICIPAL DE BOM JESUS

Resp. Téc: CARLOS ALEXANDRE ROMANI  
 ENGENHEIRO AGRÔNOMO  
 CREA-SC 172.521-8

BOM JESUS - SC  
 GOVERNO MUNICIPAL  
 R. Manoel Roratto, 454 - Centro  
 CEP: 89624-000 - Fone: (49) 3424-0181  
 www.bomjesus.sc.gov.br